

5

4

3

2

1

C



B

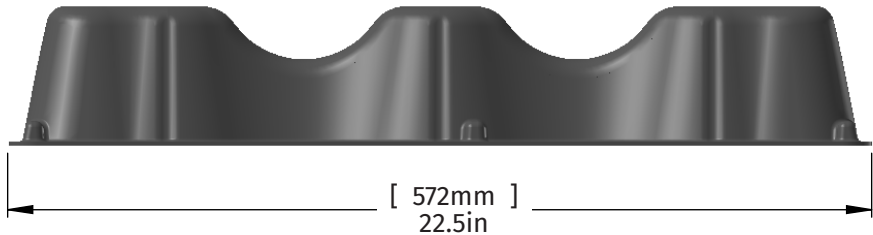

C

B

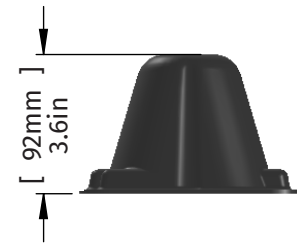
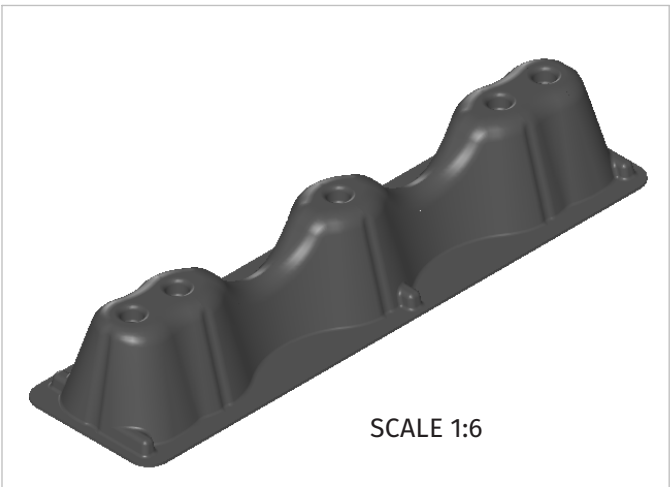

NOTES:

- Extreme Temperature Durability (~-40°F to 260°F).
- High Tensile Strength.
- Crack/Split/Leak/Rust Resistant.
- Self Extinguishing.
- Made with Pride in the USA.

UNLESS OTHERWISE SPECIFIED:

DIMENSIONS ARE IN INCHES
TOLERANCES:
FRACTIONAL ±.032
ANGULAR: MACH ±5° BEND ±2°
TWO PLACE DECIMAL ±.010
THREE PLACE DECIMAL ±.005

INTERPRET GEOMETRIC
TOLERANCING PER: ANSI Y14.5, 1994

ENGINEERING	NAME	DATE
DRAWN BY ENGINEERING	DS	6/8/2010
CHECKED BY ENGINEERING	JK	6/8/2010
ENGINEERING APPR.	CC	6/8/2010
MFG. APPR.	CC	6/8/2010

PROPRIETARY AND CONFIDENTIAL

THE INFORMATION CONTAINED IN THIS
DRAWING IS THE SOLE PROPERTY OF
RECTORSEAL.
ANY REPRODUCTION IN PART OR AS A WHOLE
WITHOUT THE WRITTEN PERMISSION OF
RECTORSEAL IS PROHIBITED.

R50258-0922



TITLE:
AG-GFR 23 x 6 x 4 SPECIFICATION SHEET
ITEM #: 96250

SIZE A	SCALE: 1:5	SHEET 1 OF 1
-----------	------------	--------------

5

4

3

2

1

A